

**Kit 2**

**General information, individual parts, assembly instructions**

**Front wall semitrailer**

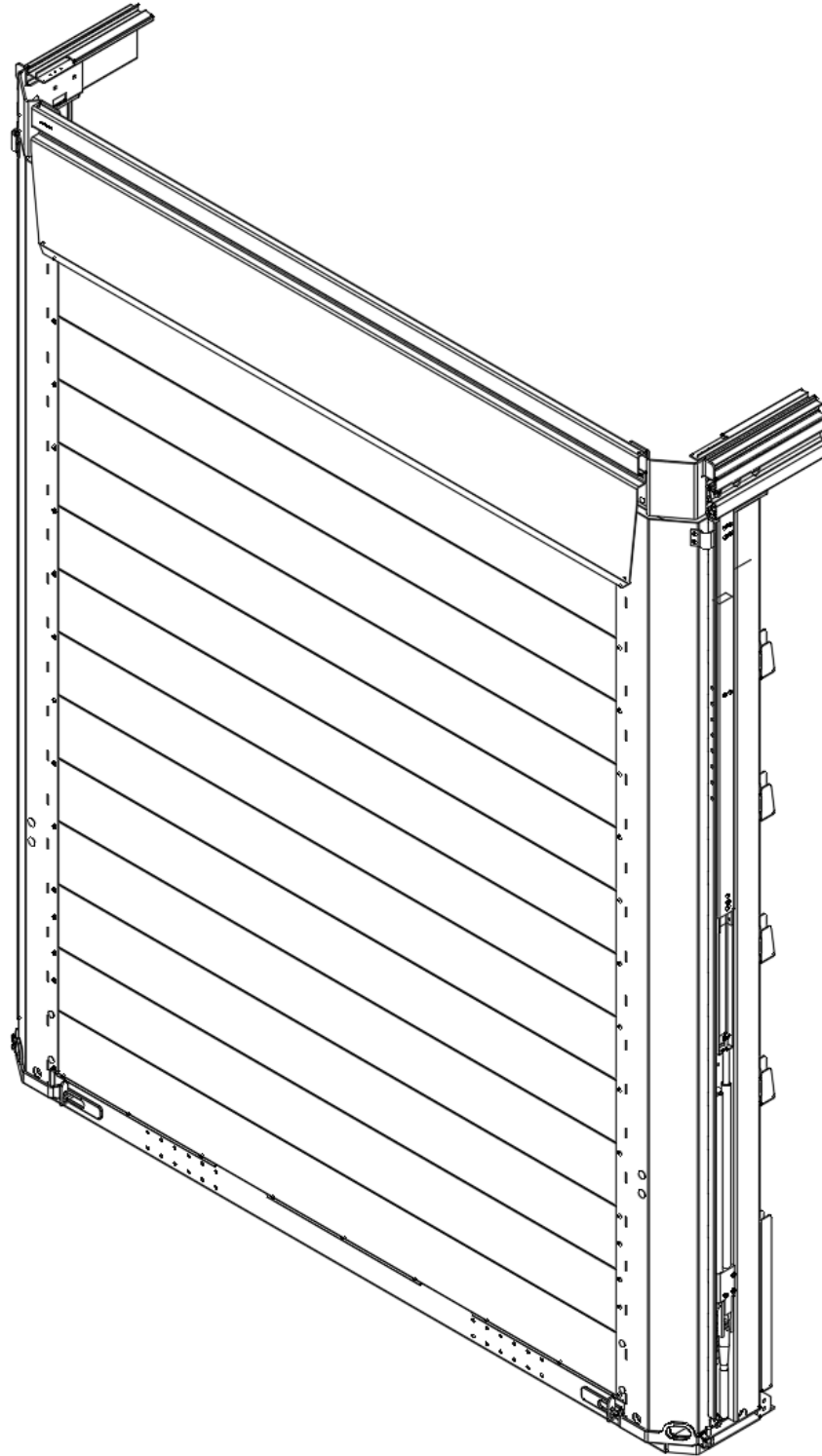

## Table of Contents

1.0.0.	General	3
2.0.0.	Security	3
3.0.0.	Front wall semi trailer	4
3.1.0.	Interfaces	
3.1.1.	Interfaces frontwall semi trailer with steel stanchions	4
3.1.2.	Interfaces frontwall semi trailer with aluminium stanchions	5
3.2.0.	Individual parts	
3.2.1.	Individual parts of frontwall semi trailer with steel stanchions	6
3.2.2.	Individual parts of frontwall semi trailer with aluminium stanchions	7
3.3.0.	Assembly	
3.3.1.	Assembly front wall	8
3.3.2.	Assembly roof connection Curtain Sider sliding roof and fixed tarpaulin roof	8
3.3.3.	Assembly roof connection Mega sliding roof	9
3.3.4.	Assembly roof connection Hamburger tilt roof	10
3.3.5.	Assembly of lift systems	10
3.3.6.	Assembly of tarpaulin tensioning system	13
3.3.7.	Assembly of the side wall connection	13
3.4.1.	Security notice	14
3.4.2.	Revision level	14

## 1.0.0

### General

#### Introduction to the assembly instructions

##### Change service:

Yes

##### Personnel:

These assembly instructions are part of the delivery and an essential aid for a successful assembly. It must therefore be available to the fitter during assembly. Furthermore, the installation guidelines of the respective vehicle manufacturer must be observed.

##### Copyright

TSE Trailer System Engineering GmbH & Co. KG owns the copyright for these assembly instructions.

If you still need further information, please contact us at

TSE Trailer System Engineering GmbH & Co. KG

Bei der Mühle 4

72365 Ratshausen Telefon:

+49 (0)7427 / 92 33-0 Telefax:

+49 (0)7427 / 92 33-75 Email:

verkauf@tse-trailersystems.de

Homepage: www.tse-trailersystems.de

## 2.0.0

### Sicherheit

#### General

Although our products are in accordance with the state of the art, they may pose a risk if:

- they are mounted by unskilled personnel
- they are maintained improperly

#### Safety Hints

This safety instruction informs you about the products of TSE Trailer System Engineering GmbH & Co. KG. It contains information about maintenance and repair of the parts and their components. The service instruction has only been written for skilled personnel of qualified and authorized specialized companies in motor vehicle crafts. The service instruction is not applicable for other target groups.

We want to support specialized companies with the present mounting instruction during the mounting works with our products.

TSE Trailer System Engineering GmbH & Co. KG accepts no liability for the installation of inapplicable or unreleased parts in their products.

Defects due to wrong handling, aggressive cleaning agents, use of force or subsequent changes of the delivered product or single components of it, as well as non-observance of the safety hints and consequential damages caused thereby, are not covered by our warranty.

Only use unchanged original parts and accessories supplied by the manufacturer.

We do not accept any warranty for the correctness, completeness or currency of the given information.

The contents and information of this mounting instruction are neither a warranty or warranted characteristics within the meaning of German legislation, respectively the German Civil Code (Bürgerliches Gesetzbuch (BGB)), nor can they be interpreted as such.

No claims can be derived from provision of information, recommendation or consulting. Liability for damages is generally excluded as far as we are not responsible in the sense of intent or gross negligence, or as far as this does not contradict mandatory legal provisions.

Texts and graphics are subject to our rights of use; copy rights or right of distribution in any form require our agreement.

Mentioned brand names, even if they are not marked as such in every case, are still subject to the regulations of the trade mark law.

If any disputes of legal nature occur from applying information found in this mounting instruction, they shall solely be subject to the regulations of German law.

The Amtsgericht Stuttgart (Local Court in Stuttgart) is deemed to be agreed on as place of jurisdiction. If some clauses of this declaration about limitation of liability do not or no longer comply with the applicable legal provisions, the validity of the other clauses shall remain unaffected thereof. Read the information in this mounting instruction carefully. Especially, obey the hints for your own safety.

All technical information, descriptions and pictures shall be valid from the day of their printing - respectively the day of any supplements hereto - on. We reserve the right to make changes due to steady further development.

No claims can be derived from applications and explanations of this publication.

#### Safety hints for the technician:

Unauthorized people are not allowed to enter the vehicle and the area around it.

Your working area should be in good order.

Only works which you are commissioned and acquainted with have to be executed.

Increased caution is advisable in dangerous areas.

Obey the producer's information and safety hints for the applicable product when you deal with operation materials (oils, grease etc.). Only applicable lifting devices may be used.

All technical information is subject to change without notice

### 3.1.1

#### Interfaces frontwall semi trailer with steel stanchions

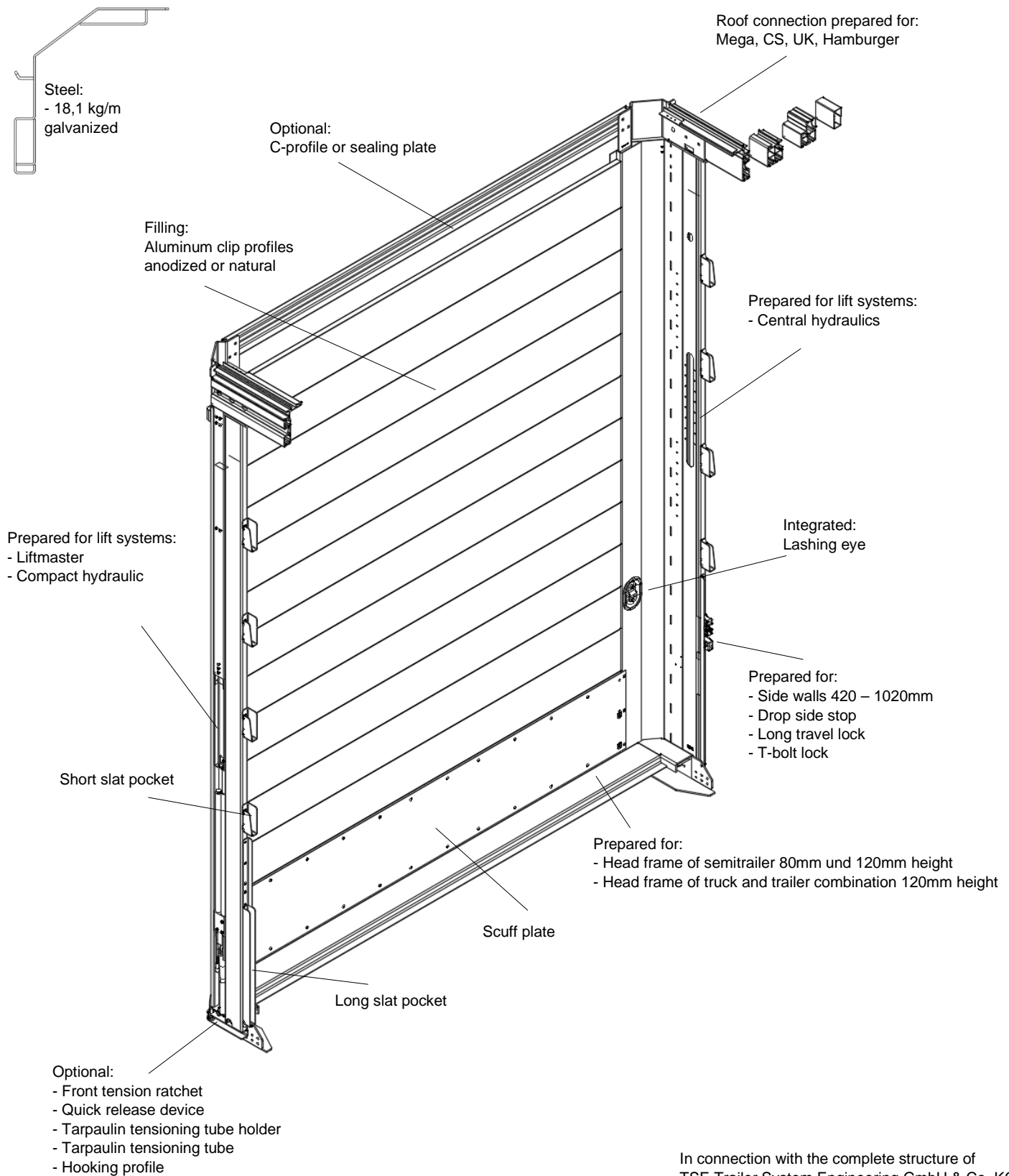

### 3.1.2

#### Interfaces frontwall semi trailer with aluminium stanchions

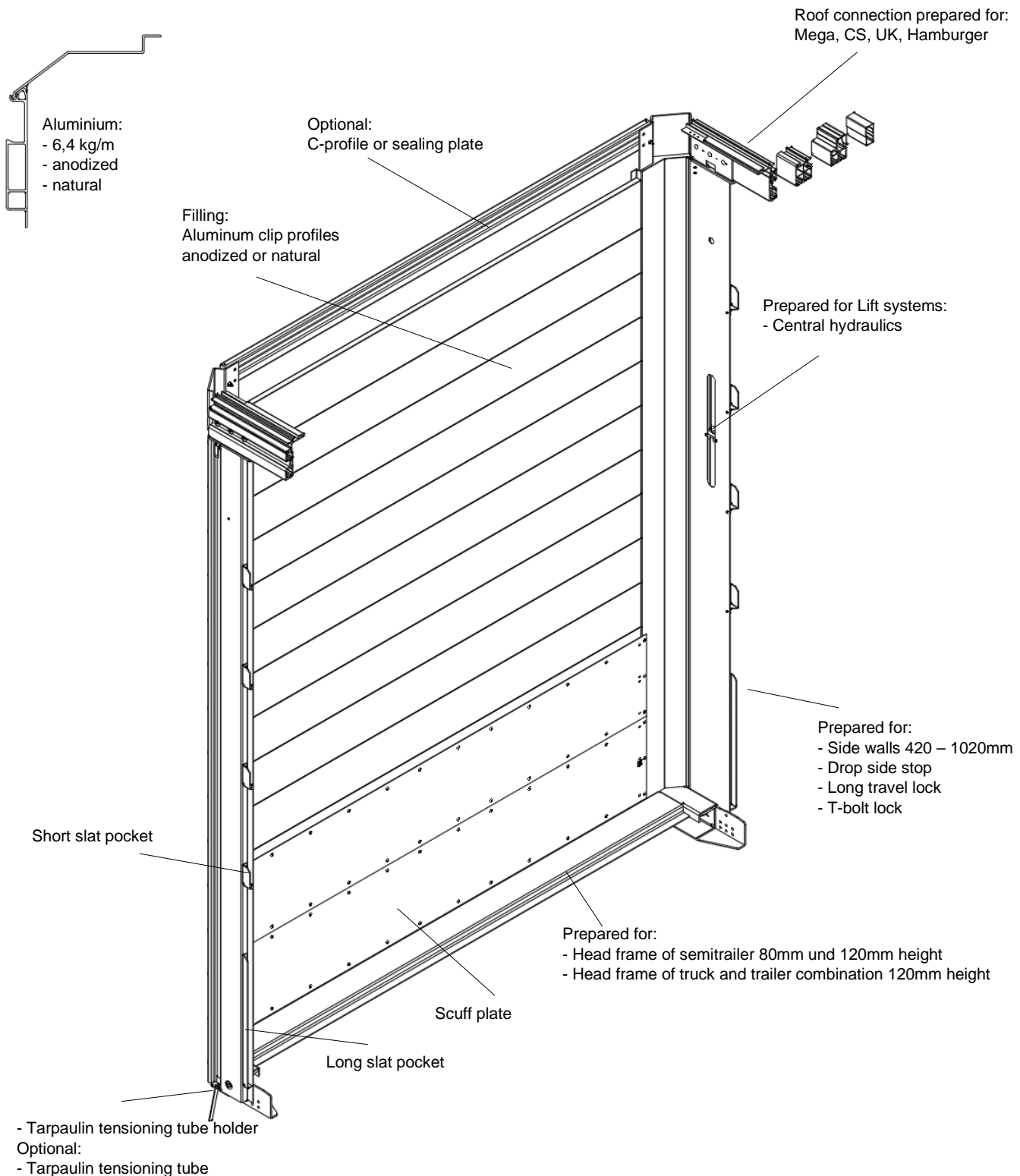

In connection with the complete structure of  
TSE Trailer System Engineering GmbH & Co. KG  
certified up to 27 tons Payload:  
- EN 12642 Code XL  
- Getränke nach VLB Handblatt  
- Reifenladung  
- Daimler R9.5





### 3.3.1

#### Assembly of the front wall

- Insert the slider from below and screw the screws hand-tight
- Align the front wall 90°
- tighten the screws

Cylinder screw: M16x50  
Hexagon nut: M16  
Washer: B17  
Tightening torque: 206 Nm

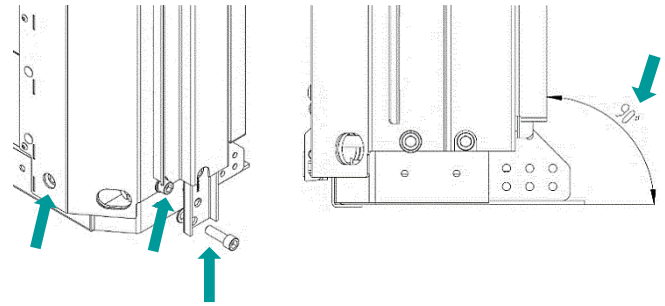

- Screw the lower profile to the head frame

Flat head screw: M8 x25  
hexagon nut: M8  
Washer: A8.4  
Tightening torque: 36 Nm

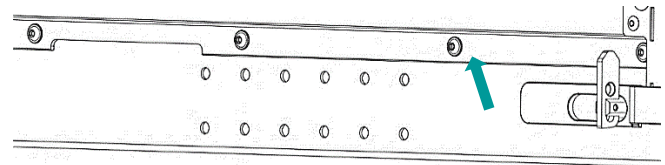

### 3.3.2

#### Assembly roof connection Curtain Slider sliding roof and fixed tarpaulin roof

##### Assembling the slider and top part

- Place the top part and intermediate plate on the slider and turn counterclockwise

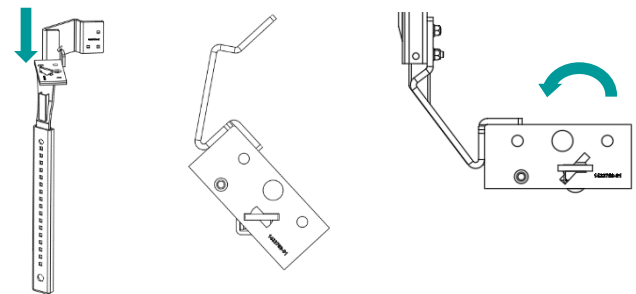

- Insert the top part with the slider into the stanchion
- if an optional stanchion lift system is available, the top part is screwed to the lift system with the countersunk screw

Countersunk screw: M8x25  
Tightening torque: 36 Nm

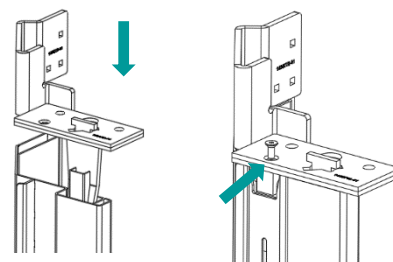

##### Assembly of the sealing plate

- Attach the sealing plate to the top part with lock screw, nut and washer
- Tighten the nuts and open them again slightly
- The sealing plate must still be able to rotate when lifting

Lock screw: M8x25  
Washer: A8.4  
Hexagon nut: M8  
Tightening torque: 25 Nm

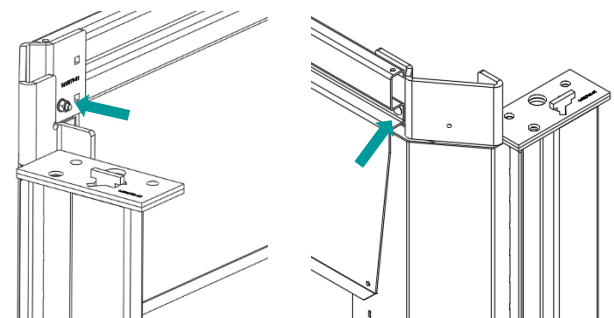



### Assembly of the C-profile

- Loosely fasten the clamping part to the top part with lock screws, washers and nuts
- Slide the C-profile on both sides between the clamping part and the top part and align
- Tighten the nuts

Lock screw: M8x25

Washer: A8.4

Hexagon nut: M8

Tightening torque: 25 Nm

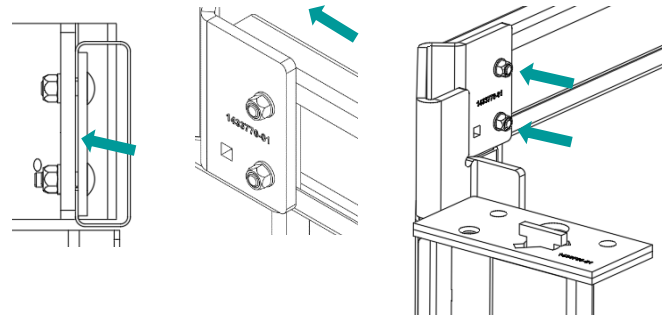

- When using a C-profile, please screw the slide to the stanchion
- use the visible square hole on the slide as a drilling template
- drill a hole from the inside with a 10.5 mm drill, deburr it, seal the surface
- screw the slide to the lock screw, washer and nut

Lock bolt: M10x25

Hexagon nut: M10

Washer: A10.5

Tightening torque: 48 Nm

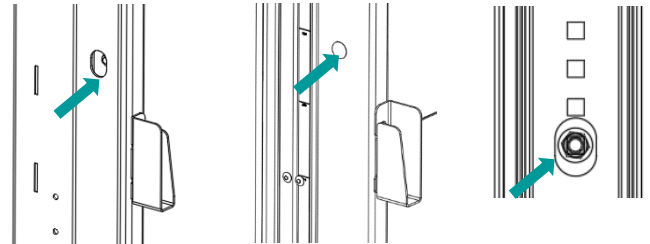

## 3.3.3

### Assembly roof connection Mega sliding roof

#### Assembling the slider and top part

- Slide the top part onto the slider

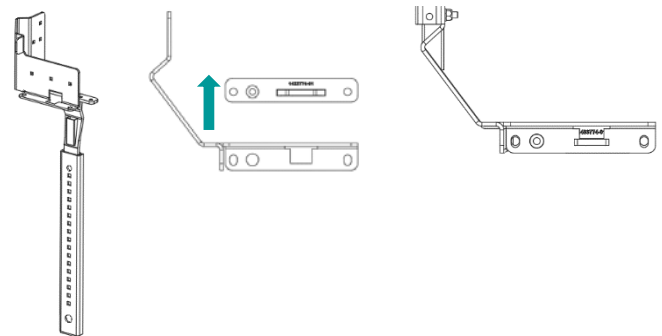

- Insert the top part with the slider into the stanchion
- If an optional stanchion lift system is available, the top part is screwed to the lift system with the countersunk screw

Countersunk screw: M8x25

Tightening torque: 36 Nm

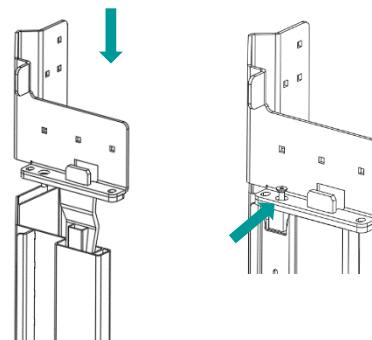

#### Assembly of the sealing plate

- Attach the sealing plate to the top part with lock screw, nut and washer
- Tighten the nuts and open them again slightly
- The sealing plate must still be able to rotate when lifting

Lock screw: M8x25

Washer: A8.4

Hexagon nut: M8

Tightening torque: 25 Nm

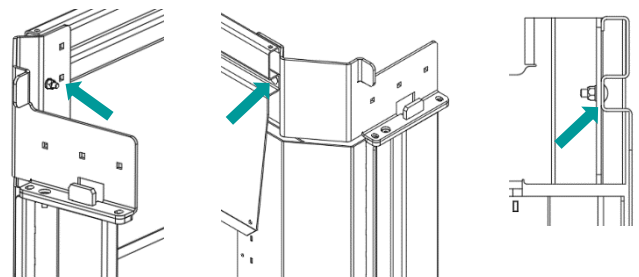

### 3.3.4

#### Assembly roof connection Hamburger tilt roof

##### Assembling the slider and top part

- Slide the top part onto the slider

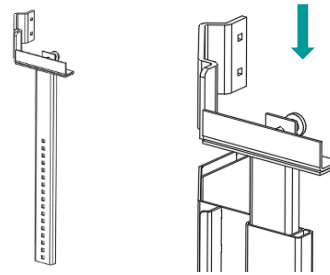

##### Assembly of the C-profile

- Loosely fasten the clamping part to the top part with lock screws, washers and nuts
- Slide the C-profile on both sides between the clamping part and the top part and align
- Tighten the nuts

Lock screw: M8x25

Washer: A8.4

Hexagon nut: M8

Tightening torque: 25 Nm

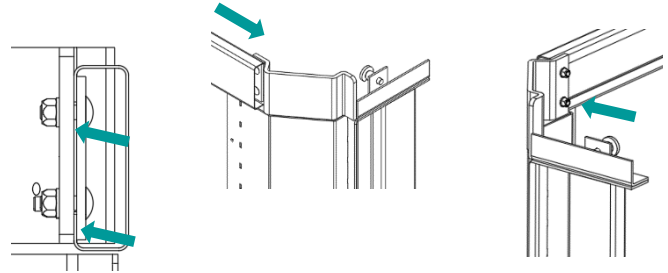

- When using a C-profile, please screw the slide to the stanchion
- use the visible square hole on the slide as a drilling template
- drill a hole from the inside with a 10.5 mm drill, deburr it, seal the surface
- screw the slide to the lock screw, washer and nut

Lock bolt: M10x25

Hexagon nut: M10

Washer: A10.5

Tightening torque: 48 Nm

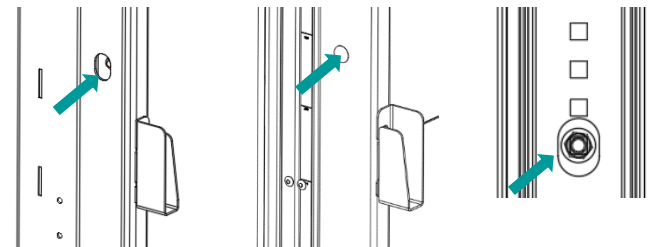

### 3.3.5

#### Assembly of lift systems

##### Liftmaster

- The lift system is screwed to the top part with the countersunk screw on the lift system
- Rivet the lift system to the stanchion with Hemlok rivets
- Rivet the handle with the lift system to the required length
- After the lift system has been attached, remove the locking pin

Countersunk screw: M8x25  
Tightening torque: 36 Nm

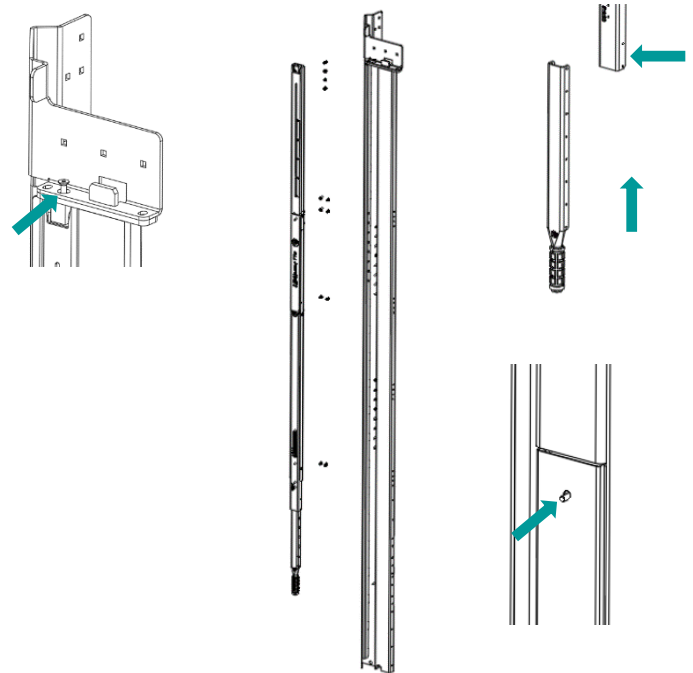

##### Rungenlifter

- rivet the sliding tube to the stanchion
- insert the sliding tube into the sliding tube from below
- the slider is screwed to the top part with the countersunk screw
- screw the hydraulic unit to the stanchion with 3 flat head screws
- connect the lifting cylinder to the slider with 2-ear clamps
- for tank ventilation the tank cap must be "snapped on"

Countersunk screw: M8x25  
Tightening torque: 36 Nm  
Flat head screw: M6x25  
Tightening torque: 15 Nm

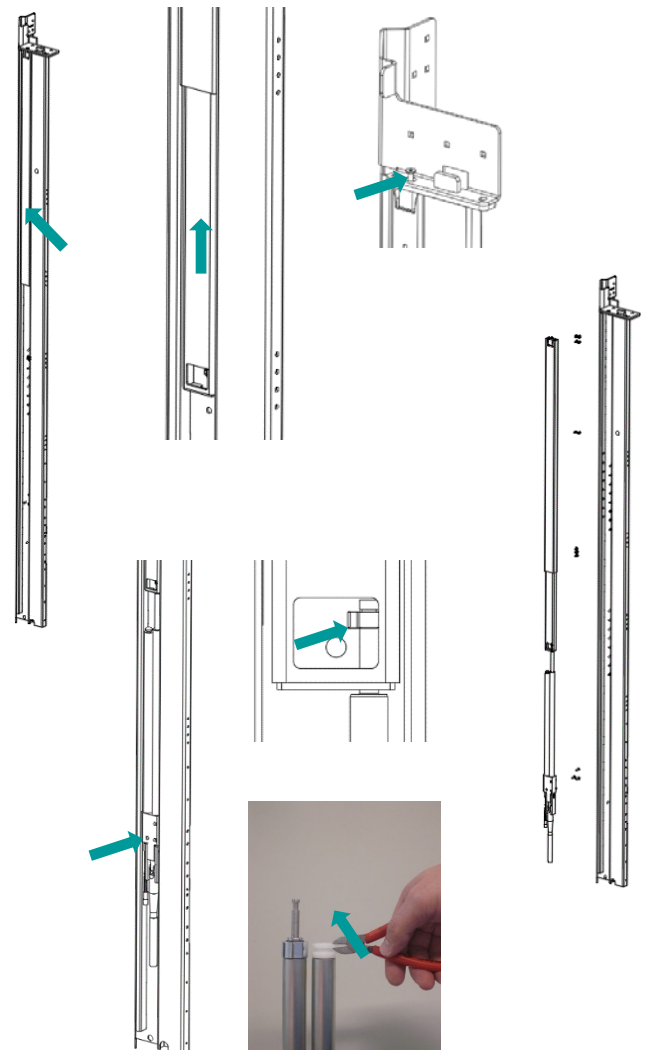

### Central hydraulics

- slide the cylinder holder onto the cylinder, tighten with the sleeve and nut

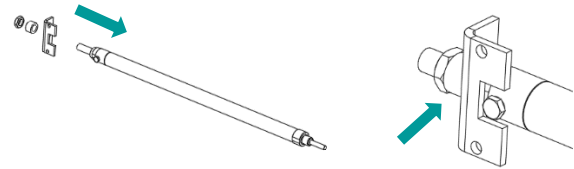

- Push the lifting cylinder into the slider and secure with a splint pin

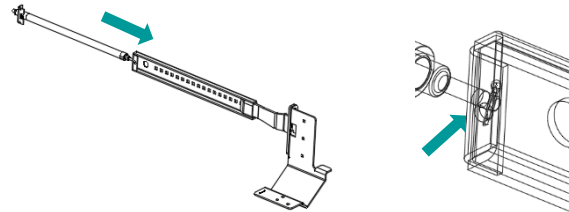

- Push the slide with the hydraulic cylinder into the stanchion
- If the hydraulic tube has been screwed to the cylinder, it can also be pushed in at the same time
- We recommend that you carry out this process with a front wall lying flat

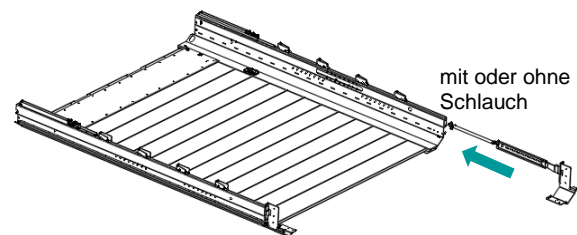

- Rivet the cylinder holder to the stanchion

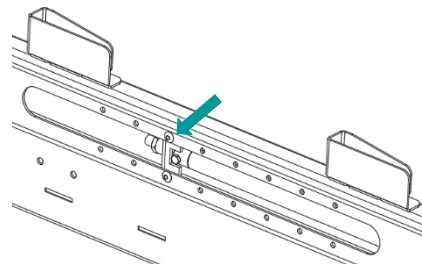

- If not already done, screw the hydraulic tube to the cylinder



### 3.3.6

#### Assembly of tarpaulin tensioning system

##### Tarpaulin tensioning tube holder

- Bolt the tarpaulin tensioning tube holder when installing the bulkhead

Cylinder screw: M16x50  
Hexagon nut: M16  
Washer: B17  
Tightening torque: 206 Nm

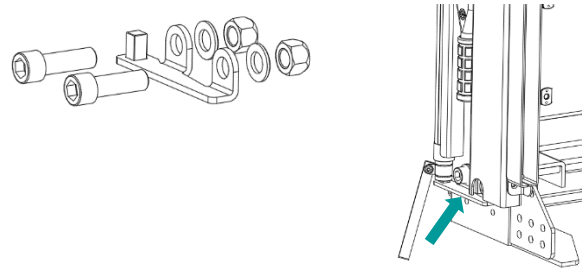

##### Front tension ratchet

- screw to the head frame with a screw, washer and nut

Cylinder screw: M8x25  
Washer: A8.4  
Hexagon nut: M8  
Tightening torque: 25 Nm

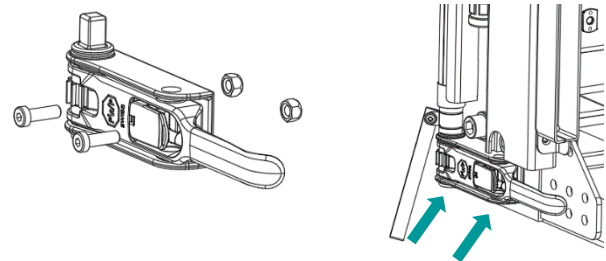

##### Quick release device

- screw the quick release device when installing the front wall

Cylinder screw: M16x50  
Hexagon nut: M16  
Washer: B17  
Tightening torque: 206 Nm

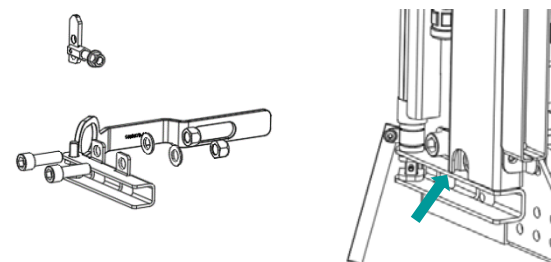

- Screw the quick release device to the head frame with a nut and washer

Washer: A12  
Hexagon nut: M12  
Tightening torque: 73 Nm

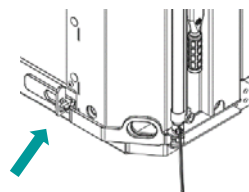

### 3.3.7

#### Assembly of the side wall connection

- Rivet the side wall stop with countersunk rivets on the stanchion
- Screw the side wall connection with the countersunk screws and counter bearing to the stanchion in the desired position

Countersunk screw: M8x25  
Tightening torque: 36 Nm

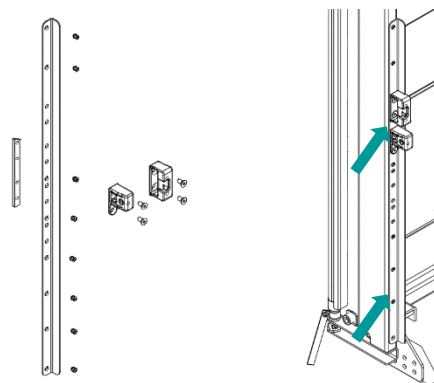

### 3.4.1

#### Security notice

Attention:

The surfaces of the TSE parts and assemblies may not be contaminated with corrosive cleaning fluids.

Cleaning fluids with the appropriate labeling are aggressive and can cause damage to all component surfaces.

These should expressly not be used for gentle cleaning.

Nummer	Symbol
GHS05	Caustic effect



### 3.4.2

#### Revision level

Revisionsstand	Art der Änderung	Datum	Name
00	New creation of the assembly instructions	01.12.2020	Boll
01	Page 8 changed	26.03.2021	Boll

Erstellt	Geprüft und Freigegeben
Datum: 04.12.2020 Name/Abt. Uwe Boll Unterschrift	Datum: 04.12.2020 Name/Abt. Uwe Boll
Dokument: 1456026	